

PICA CUBE™ WNC

DESIGNED BY THE BLACK TANK



Brilliant Tunable White Light

The Pica Cube™ WNC packs an unprecedented 22-24 watts of output into a 2.5 inch cube! Utilizing Black Tank's Gen2 controls and patented heat management technology, Pica Cube WNC provides an amazing amount of high quality light for clean and simple installations for archtainment, retail, cruise ship, museum, and architectural illumination applications.

Sharing the same best in class Warm, Neutral and Cool White Cree XML 4W emitters used in Pica's bigger siblings, the Miro and Braq Cubes®, the WNC is capable of generating 2700k to 6500k white light at up to 92 CRI output.

Pica Cube can be powered via AC Mains (100-240VAC) using an available power-supply and controlled using standard DMX or in standalone mode via its easy-to-use on-board controls. The optional Pica Portal is capable of powering and controlling up to four Pica Cubes by providing power and data through a common Cat5 (24 AWG) cable.

The Pica Cube is also offered in an all Warm White (3W) package and an all Neutral White (3N) package.

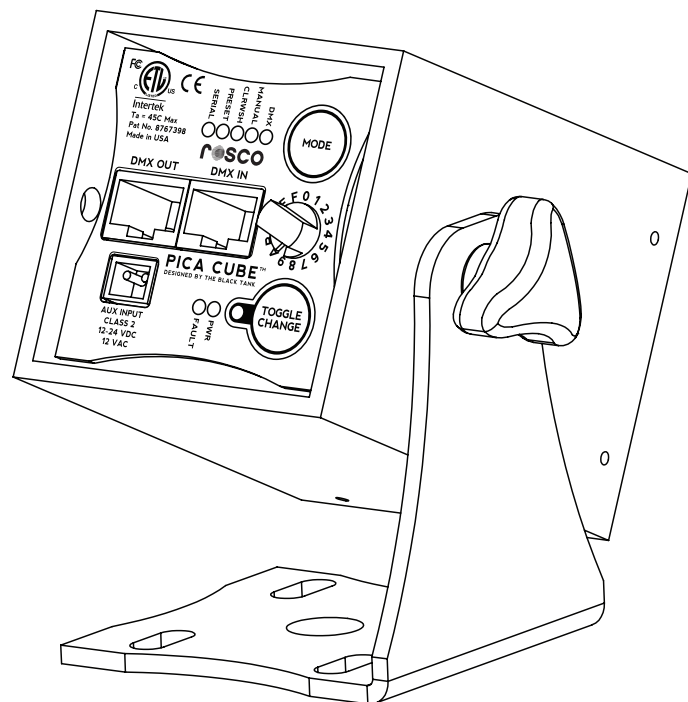

Key Features

- Balanced assortment of warm, neutral and cool LEDs provide a bright yet versatile punch of white light
- Unique patented (US Patent No. 8,767,398) heat management system packs the most lumens into the smallest form factor
- Variable power input from 12-24VDC or 12VAC enables versatile power options
- Over 90 luminaires on a single 20A circuit
- Modular design easily configures in strips and arrays for maximum versatility
- Flicker-free dimming in 8 or 16 bit resolution
- Intuitive on-board controls
- Easily installed in many applications using CAT5 cable that carries Power + Data
- Full assortment of spot, medium and wide lenses included
- Novel "filament mode" mimics the delayed blackout glow of incandescent fixtures



SPECIFICATIONS

| | |
|--------------------|--|
| Input Voltage: | 12-24VDC or 12VAC |
| Power Consumption: | 22W (DC Input) or 24W (AC Input) at 100% Output |
| Power Input: | Power Adapter (100-240VAC In/12-24VDC Out) or CAT5 (Power +Data) |
| LED: | 3 X 4W Cree XM-L2 LEDs |
| Lumen Maintenance: | 50,000 hours L50 at 45C 100,000 hours L50 at 25C (LM-79-08 Standard) |
| Data: | DMX, RJ45 Connectors |
| Output: | 1005 Lumens |
| Color Temperature: | WNC: 2700K - 6500K 3W: 2700K 3N: 4000K |
| Operation: | DMX: 8 or 16 bit DMX512/Manual: Rotary Knob |
| Operating Temp.: | -13° to 113° F (-20° to 45° C) |
| Humidity: | 0 - 95% non-condensing |
| Dimensions: | 2.5in x 2.5in x 3.6 in (63.5mm x 63.5mm x 91mm) |
| Weight: | 0.9 lbs (0.41kg) |
| Housing: | Powder Coated Aluminum Extrusion (1/8" wall) |
| Approvals: | FCC Class A Radiated and Conducted ETL / UL Standards 1573 and 8750 cETL / CSA C22.2 #166-M1983 CE / IP20 Rated |

PICA CUBE ACCESSORIES

| |
|--------------------------------------|
| Top Hat |
| Egg Crate Louver |
| Barn Doors (Set of 4) |
| Mounting Hardware |
| Symmetrical & Asymmetrical Diffusers |
| Wall Power Adapter |
| Pica Portal 125 |

PART NUMBERS

| | |
|------------|----------------|
| WNC Black: | 515 90200 1020 |
| WNC White: | 515 90200 2020 |
| 3W Black: | 515 90200 1021 |
| 3W White: | 515 90200 2021 |
| 3N Black: | 515 90200 1022 |
| 3N White: | 515 90200 2022 |

WHAT'S IN THE BOX

| |
|--|
| Pica Cube |
| Set of Symmetrical Spread Lenses |
| Requires Wall Adapter or Pica Portal for power |

All LEDs On

Without Diffuser



Polar Candela Distribution

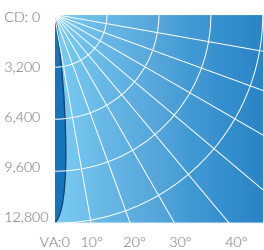

VA:0 10° 20° 30° 40°

Illuminance at a Distance

| Center Beam LUX | Beam Width |
|-----------------|------------|
| 0.5m: 51,210 | 0.1m |
| 1.0m: 12,802 | 0.2m |
| 1.5m: 5,690 | 0.3m |
| 2.0m: 3,201 | 0.4m |
| 2.5m: 2,048 | 0.6m |
| 3.0m: 1,423 | 0.7m |

Beam Spread: 13°

All LEDs On

With 20° Diffuser

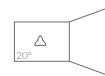

Polar Candela Distribution

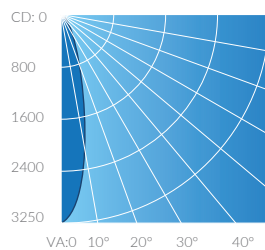

VA:0 10° 20° 30° 40°

Illuminance at a Distance

| Center Beam LUX | Beam Width |
|-----------------|------------|
| 0.5m: 12,987 | 0.2m |
| 1.0m: 3,247 | 0.4m |
| 1.5m: 1,443 | 0.7m |
| 2.0m: 812 | 0.9m |
| 2.5m: 520 | 1.1m |
| 3.0m: 361 | 1.3m |

Beam Spread: 25°

All LEDs On

With 40° Diffuser

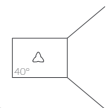

Polar Candela Distribution

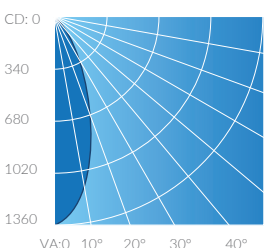

VA:0 10° 20° 30° 40°

Illuminance at a Distance

| Center Beam LUX | Beam Width |
|-----------------|------------|
| 0.5m: 5,440 | 0.3m |
| 1.0m: 1,360 | 0.6m |
| 1.5m: 605 | 1.0m |
| 2.0m: 340 | 1.3m |
| 2.5m: 218 | 1.7m |
| 3.0m: 151 | 2.0m |

Beam Spread: 39°

All LEDs On

With 60° Diffuser

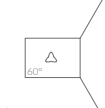

Polar Candela Distribution

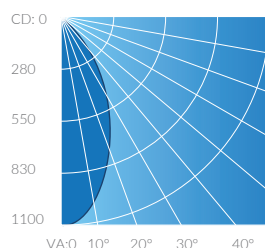

VA:0 10° 20° 30° 40°

Illuminance at a Distance

| Center Beam LUX | Beam Width |
|-----------------|------------|
| 0.5m: 4,427 | 0.4m |
| 1.0m: 1,107 | 0.9m |
| 1.5m: 492 | 1.3m |
| 2.0m: 277 | 1.7m |
| 2.5m: 177 | 2.1m |
| 3.0m: 123 | 2.6m |

Beam Spread: 49°